

# SHIMANO®

**SHIMANO EUROPA**  
 Industrieweg 24 NL-8071 CT Nunspeetâ Holland  
 Phone 31-3412-72222

**SHIMANO AMERICAN CORPORATION**  
 One Holland Irvine CA 92618 U.S.A.  
 Phone 949-951-5003

## Spare parts list for after market.

- You may photocopy this sheet and use it as an order form.
- Sie können dieses Blatt kopieren und als Bestellformular verwenden.
- Vous pouvez photocopier cette feuille et l'utiliser comme bon de commande.
- Dit blad kan gecopieerd en als bestelformulier gebruikt worden.
- Potete fotocopiare questo foglio e usarlo come modulo di commissione.

### SHIMANO NEXUS 7-SPEED HUB w/Hi-Power Roller Brake **SG-7R42** Inter-7 Hub **BR-IM41-R** Inter-M Brake

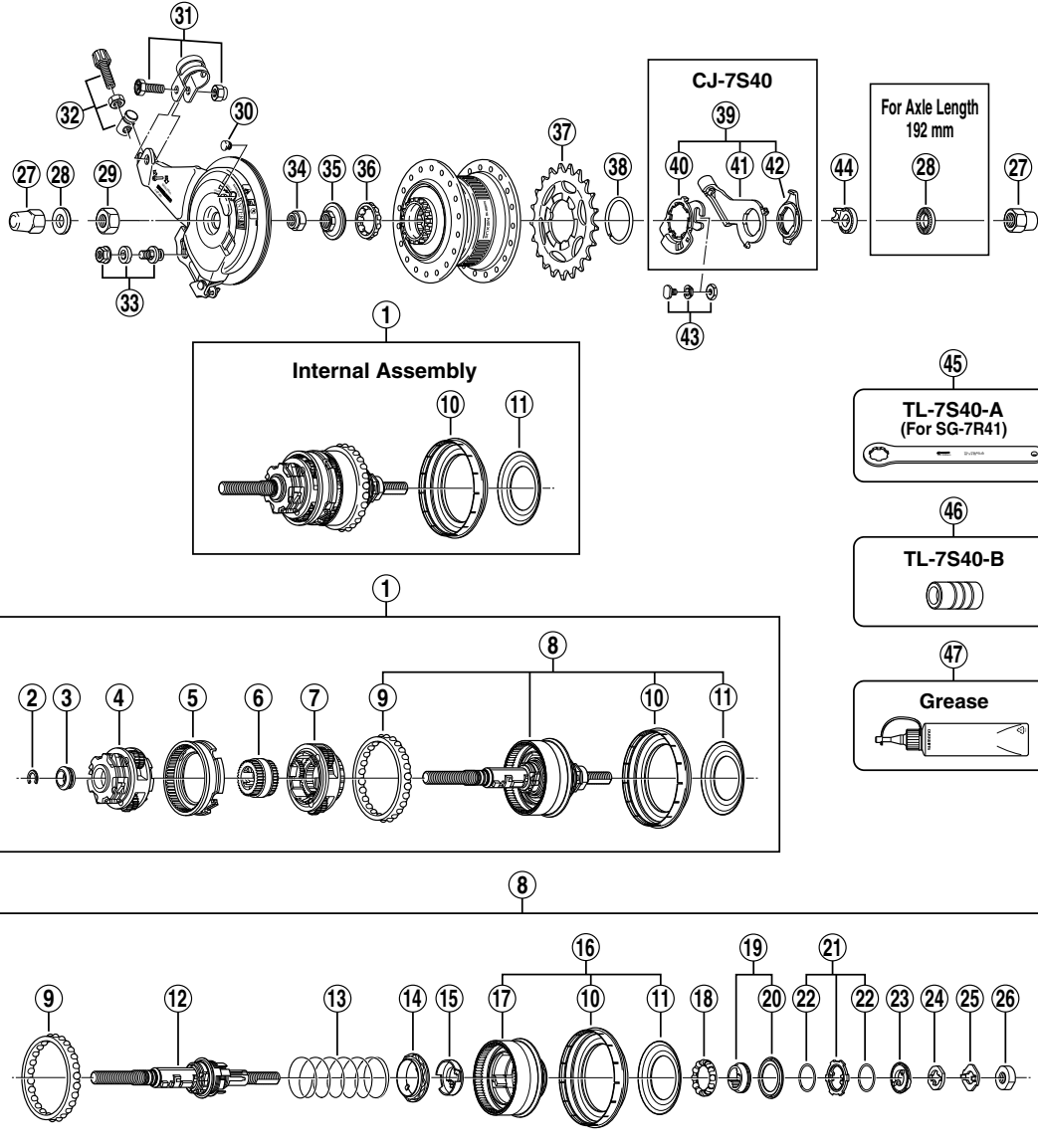

ITEM NO.	SHIMANO CODE NO.	DESCRIPTION
1	<b>33E 9801</b>	Internal Assembly (Axle Length 176 mm)
	<b>33E 9802</b>	Internal Assembly (Axle Length 192 mm)
2	<b>308 0700</b>	Stop Ring for Carrier Guide 2
3	<b>33E 0300</b>	Carrier Guide 2
4	<b>33E 9807</b>	Carrier Unit 2
5	<b>308 9804</b>	Ring Gear Unit 2
6	<b>33F 9806</b>	Sun Gear Unit 2 & 3
7	<b>330 9806</b>	Carrier Unit 1
8	<b>33E 9803</b>	Axle & Driver Unit (Axle Length 176 mm) w/Ball Retainer M, Right Hand Dust Cap B & C
	<b>33E 9804</b>	Axle & Driver Unit (Axle Length 192 mm) w/Ball Retainer M, Right Hand Dust Cap B & C
9	<b>330 9180</b>	Ball Retainer M (3/16" x 26)
10	<b>33Z 2500</b>	Right Hand Dust Cap B
11	<b>33Z 2600</b>	Right Hand Dust Cap C
12	<b>33E 9805</b>	Axle Unit (Axle Length 176 mm)
	<b>33E 9806</b>	Axle Unit (Axle Length 192 mm)
13	<b>330 2400</b>	Return Spring A
14	<b>33Z 1000</b>	Gear Shifting Cam
15	<b>33Z 1100</b>	Feed Cam
16	<b>308 9811</b>	Driver Unit w/Right Hand Dust Cap B & C
17	<b>308 9812</b>	Driver Unit
18	<b>330 9160</b>	Ball Retainer F (3/16" x 12)
19	<b>33Z 9803</b>	Right Hand Cone w/Seal
20	<b>33Z 2800</b>	Right Hand Cone Seal
21	<b>33F 9804</b>	Driver Plate w/Seal
22	<b>330 1200</b>	Driver Plate Seal
23	<b>330 9050</b>	Lock Washer
24	<b>33Z 0900</b>	Cam Washer
25	<b>33Z 0800</b>	Stop Washer
26	<b>308 0302</b>	Right Hand Lock Nut (6 mm)
27	<b>314 1401</b>	Cap Nut (3/8")
28	<b>220 0604</b>	Washer (3.2 mm)
29	<b>75V 1300</b>	Brake Unit Fixing Nut (8.2 mm)
30	<b>75V 1601</b>	Grease Hole Cap
31	<b>33F 9807</b>	Brake Arm Clip Unit (5/8")
	<b>33F 9808</b>	Brake Arm Clip Unit (3/4")
32	<b>75P 9803</b>	Brake Cable Adjusting Bolt Unit
33	<b>75P 9805</b>	Inner Cable Fixing Bolt Unit
34	<b>31Z 0602</b>	Lock Nut for Left Hand Cone
35	<b>308 9807</b>	Left Hand Cone w/Dust Cap
36	<b>308 9808</b>	Ball Retainer I (3/16" x 11)
	<b>322 0322</b>	Sprocket Wheel 16T (Silver)
	<b>322 0342</b>	Sprocket Wheel 18T (Silver)
	<b>322 0352</b>	Sprocket Wheel 19T (Silver)
	<b>322 0362</b>	Sprocket Wheel 20T (Silver)
	<b>330 6000</b>	Sprocket Wheel 21T (Silver)
	<b>330 6010</b>	Sprocket Wheel 22T (Silver)
37	<b>322 0322</b>	Sprocket Wheel 16T (Silver)
	<b>322 0342</b>	Sprocket Wheel 18T (Silver)
	<b>322 0352</b>	Sprocket Wheel 19T (Silver)
	<b>322 0362</b>	Sprocket Wheel 20T (Silver)
	<b>330 6000</b>	Sprocket Wheel 21T (Silver)
	<b>330 6010</b>	Sprocket Wheel 22T (Silver)
38	<b>321 2000</b>	Snap Ring
39	<b>74Y 9801</b>	CJ-7S40 Cassette Joint Unit
40	<b>74Y 0200</b>	Cassette Joint Pulley
41	<b>74Y 9802</b>	Cassette Joint Bracket
42	<b>33Z 9802</b>	Cassette Joint Fixing Ring
43	<b>74Y 9803</b>	Inner Cable Fixing Bolt Unit for CJ-7S40
	<b>33Z 2010</b>	Non-turn Washer 1 (Black)
	<b>33Z 2020</b>	Non-turn Washer 2 (Yellow)
	<b>33Z 2030</b>	Non-turn Washer 3 (Silver)
44	<b>308 8800</b>	TL-7S40-A Right Hand Lock Nut Tool for SG-7R41
	<b>308 8900</b>	TL-7S40-B Right Hand Cone Tool
	<b>041 2060</b>	Internal Hub Grease (Net. 100g)
	<b>041 2040</b>	Roller Brake Grease (Net. 100g)